

Level 3

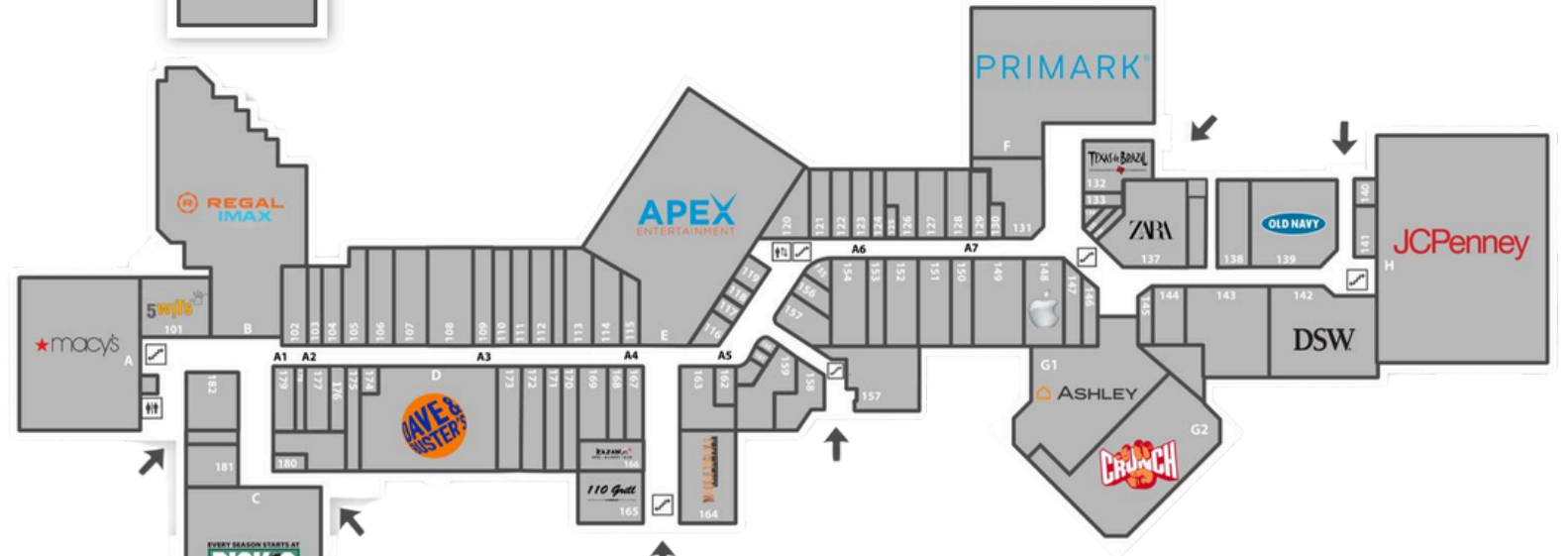

Level 2



Level 1

- | | | | | | | | | | |
|-----------------|------------------------------|-----------|---------------------------------------|---------|-----------------------------|---------|------------------------------------|-----------|---------------------------|
| 164 | 110 GRILL | 153 | CLARK'S | 173 | HEALTH MAGIC-COMING SOON | 117 | MRS. FIELDS | 275 | SPENCER'S GIFTS |
| 101 | 5 WITS | 205 | COSTCO RECRUITMENT CENTER-COMING SOON | 152 | HOLLISTER | 156 | NEWBURY COMICS | 216 | STARBUCKS |
| 154 | AEROPOSTALE | 281 | CREATE BARBER LOUNGE | 128 | HOT TOPIC | 233 | NEW CROWN FRIED CHICKEN | 141 | STUFFY RIDERS-COMING SOON |
| 167 | AIM POINT | G2 | CRUNCH FITNESS | 213 | IBROWS | 239 | NONNA & OMA'S | 278 | SUNGLASS HUT |
| 237 | ALL IN ADVENTURES | 214 | CUSTOM-WORLD | 178 | I FIX HERE | 135 | LUSH | 231 | SWAROVSKI |
| 159 | ALOHA KRAB | D | DAVE & BUSTER'S | F | GOING GOING GONE | 150 | OAKLEY | 261 | TACO BELL |
| 225 | ALTERNATIVE | C | DICK'S SPORTING GOODS | 215 | THE INSPIRATION CO. | 122 | OFFLINE BY AERIE | 132 | TEXAS DE BRAZIL |
| 149 | AMERICAN EAGLE/AERIE | 263 | DOLLAR N THINGS | 110 | IT'SUGAR | 139 | OLD NAVY | 175 | T-MOBILE |
| E | APEX ENTERTAINMENT | 208 | DRYGOODS | 251 | J. JILL | 134 | ORANGE JULIUS | 177 | TOP DROPZ |
| 204 | APPLE | 142 | DSW | 271 | JAY STREET VIDEO GAMES | 248 | ORA SEMPRE | 284 | TOY REPUBLIC |
| 148 | ARCADE HOUSE | 219 | DUNKIN' DONUTS | H | JCPENNEY | 202 | OTAKU HOUSE | 288 | TRACK 23 |
| 115 245 289 | ARCH | 210 | EARTHBOUND TRADING CO. | 272 | JD SPORTS | 232 | PAC SUN | 120 | TREASURE OUTLET |
| 240 | ARTIQUE | 102 | EASTERN WONDERS BOUTIQUE | 104 | JIMMY JAZZ SNIPES | 232 | PANDORA | 290 | TSS PRINTING |
| G1 | ASHLEY FURNITURE-COMING SOON | 230 | EDEN JEWELERS | 270 | JOSEPH JACOB JEWELERS | A1 B1 | PERFUME CENTER | 131 | URBAN OUTFITTERS |
| 119 | AT&T MOBILITY | 181 | EMPEROR GARDEN | 121 | JOURNEYS | 201 | PERFUME DE LUX | 153 | VANS |
| 160 | AUNTIE ANNE'S | 207 | EXPRESS | 168 | JOURNEYS KIDZ | 266 | PLAY FUNIA | 223 | VERIZON WIRELESS |
| 244 | BANANA REPUBLIC | 222 | EXPRESS JEWELERS | 260 | JUICE ETERNITY | 146 | POPEYE'S | 114 | VIA ROMA |
| A7 | BANTER BY PIERCING PAGODA | 108 | FAMOUS FOOTWEAR | 269 | KAY JEWELERS | 234 | PRETZEL MAKER | 279 | VICTORIA'S SECRET/PINK |
| M | BARNES AND NOBLE-COMING SOON | 203 | FANZONE | 165 | KAZAN RAMEN & BBQ | F | PRIMARK | 249 | WAFFLES N CREPES |
| 227 | BATH & BODY WORKS | 241 | FIX SQUAD | 212 | KIDDELTON-COMING SOON | 103 | PRINCE UFO-COMING SOON | 264 | WENDY'S |
| 221 | BERRY & BERRY | 111 | FIVE BELOW | 258 | KONG DOG | 287 | PRO IMAGE SPORTS | 136 | WEST AFRICA TREASURES |
| I | BEST BUY | 138 | FOOT LOCKER / KIDS FOOT LOCKER | 113 | LANE BRYANT / CACIQUE | 282 | Q'S LANDING ZONE | 252 | WINDSOR |
| 265 | BIBIMBOWL | 162 | FROZEN D LITE | 140 | LEE NAILS | B | RACK ROOM SHOES | 228 | YANKEE CANDLE |
| L | BILLY BEEZ | 276 | FUNNY BONE COMEDY CLUB | 123 | LEGO | J | REGAL CINEMAS | 137 236 | ZARA |
| 171 | BINS N BULLSEYE'S | 105 | FYE | 169 | LENSCRAFTERS | 118 | REI Co-op | 129 | ZUMIEZ |
| 247 | BLOODLINES | 218 | GAMESTOP | 126 | LIDS | 110 | THE REPAIR | | |
| 217 | BOWLED | 143 | GAP / GAP KIDS | 254 | LOLLOPOP TOY SHOP | 133 | ROSCOE'S GROOMING | | |
| 280 | BUCKLE | 162 | GARAGE | 246 | LOVESAC | 257 | SARAHIT MEXICAN BAKERY-COMING SOON | | |
| 226 | BUILD-A-BEAR WORKSHOP | K | GET AIR TRAMPOLINE PARK | 130 | LOVISA | 267 | SBARRO | | |
| 180 | CARHARTT | 274 | GIFT EMPORIUM | 250 | LULULEMON | 220 | SHANGHAI WOK | | |
| 106 | CHAMPS | A5 | GLOBAL TIMES | A | MACY'S | 176 | SING CHOI KEE-COMING SOON | | |
| 268 | CHARLEY'S PHILLY STEAK | 124 | GNC | 163 | MAGGIE MCFLY'S | 145 | SNACK WORLD | | |
| 206 | CHARLOTTE RUSSE | 112 | GO! CALENDARS TOYS & GAMES | 155 | MANDATI JEWELERS | 172 | SNEAKER CITY | | |
| 259 | CHINA MAX | A4 | GOLD & DIAMONDS | 285 | MESS SOCIETY-COMING SOON | 211 | SNEAK PEAK 518 | | |
| A3 | CHINA TANGHULU-COMING SOON | 161 | GONG CHA | 235 | MICHAEL KORS | 200 | THE SPOT | | |
| 174 | CINNABON | 262 277 | GRAB N GO | 209 | THE MIND BODY SPIRIT CENTER | 107 | SPACE ADVENTURE MINI GOLF | | |
| 224 | CLAIRE'S | 151 256 | H&M | A6 B3 | MOBILEXPRESS | | | | |